

[Pin Numbers and Signal Names of External Connector]

ピン番号 Pin No.	信号名 Signal name	ピン番号 Pin No.	信号名 Signal name	ピン番号 Pin No.	信号名 Signal name	ピン番号 Pin No.	信号名 Signal name	ピン番号 Pin No.	信号名 Signal name
1	DC24V	11	YD0A	21	XD06	31	YD01	41	XSCN05
2	DC24V	12	YD0C	22	XD08	32	YD03	42	XSCN07
3	DC24V	13	YD0E	23	XD0A	33	YD05	43	XD01
4	DC24V	14	XSCN00	24	XD0C	34	YD07	44	XD03
5	N.C.	15	XSCN02	25	XD0E	35	YD09	45	XD05
6	YD00	16	XSCN04	26	0V	36	YD0B	46	XD07
7	YD02	17	XSCN06	27	0V	37	YD0D	47	XD09
8	YD04	18	XD00	28	0V	38	YD0F	48	XD0B
9	YD06	19	XD02	29	0V	39	XSCN01	49	XD0D
10	YD08	20	XD04	30	RUN	40	XSCN03	50	XD0F

[External Connection Diagram]

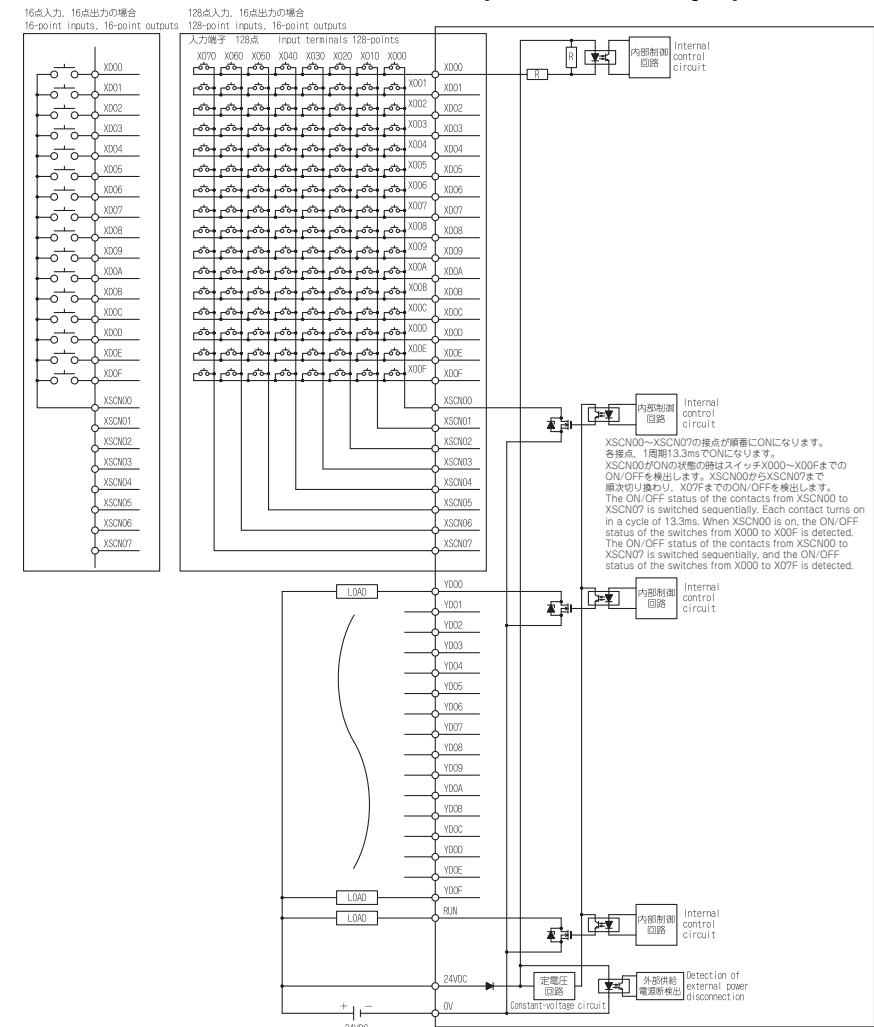

*1 When two or more switches turn on simultaneously, each switch must be provided with a diode. (Only for 128-point input, 16-point output)

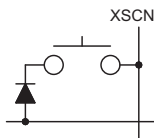

*2 Connecting a fuse (compliant with IEC60127) to the RUN output terminal is recommended so as not to burn out external devices and the unit when the load circuit is shorted.

3. 各部の名称と外形寸法

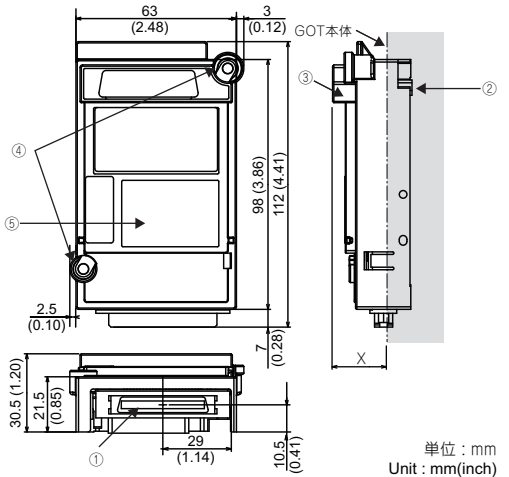

GOTの画面サイズ	GT37	GT27	GT25	GT16	GT15
15 型の場合	30.5	23	-	19.5	21
12.1 型の場合	30.5	23	23	18	18
10.4 型の場合	30.5	23	23	21	21
8.4 型の場合	30.5	23	23	23	23
5.7 型の場合	-	23	-	23	23

Dimensions of X when installing the unit on the GOT.

GOT	GT37	GT27	GT25	GT16	GT15
15"	30.5 (1.2)	23(0.91)	-	19.5 (0.77)	21 (0.83)
12.1"	30.5 (1.2)	23(0.91)	23(0.91)	18 (0.71)	18 (0.71)
10.4"	30.5 (1.2)	23(0.91)	23(0.91)	21 (0.83)	21 (0.83)
8.4"	30.5 (1.2)	23(0.91)	23(0.91)	23 (0.91)	23 (0.91)
5.7"	-	23(0.91)	-	23 (0.91)	23 (0.91)

4. 取付け方法

4.1 外部入出力ユニットの取付け方法

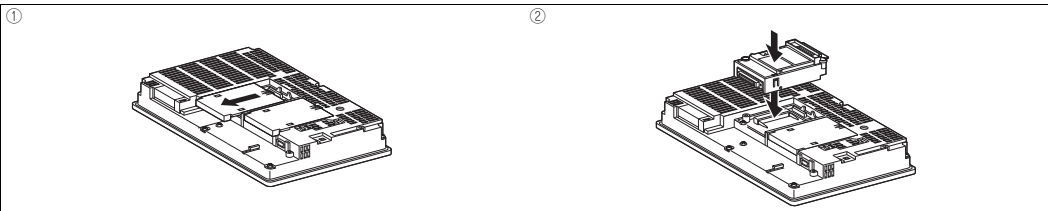

- | | |
|---|--|
| <p>① GOT の電源を OFF します。</p> <p>GOT の拡張ユニットカバー 1ヶ所を取り外します。</p> <p>② 外部入出力ユニットを GOT のケースの溝に合わせはめ込みます。</p> <p>③ 外部入出力ユニットの取付けネジ (2ヶ所) を締付けトルク 0.36 ~ 0.48 N・m で締めて固定します。</p> <p>④ 後段に拡張ユニットを装着する場合は、コネクタカバーをはずし、シールをはがします。</p> <p>後段に拡張ユニットを装着しない場合は、静電気の進入防止のため、付属のラベルを取付けネジ (2ヶ所) の頭を覆うように貼り付けます。コネクタカバーは装着したままにします。</p> <p>シールは貼り付けたまにします。</p> | <p>① Turn off the GOT.</p> <p>Remove an extension unit cover of the GOT.</p> <p>② Fit the external I/O unit in the GOT.</p> <p>③ Tighten two external I/O unit mounting screws with a torque of 0.36 to 0.48 N・m.</p> <p>④ When an extension unit is installed on unit, remove the connector cover and the sticker.</p> <p>When an extension unit is not installed on the unit, stick accessory labels over two mounting screws so as not to damage the unit by static electricity.</p> <p>Keep the connector cover fixed.</p> |
|---|--|

For removing the unit, use the reverse procedure to install the unit. Only one external I/O unit can be installed in the first stage to the third stage of an extension interface.

4.2 How to make connector for external connection

Make a connector for the external connection as shown in the following figure.

For the depth dimension and the cable bending dimensions for the GOT with the external I/O unit, refer to the User's Manual for the GOT used.

When connecting a cable for the external connection to the external I/O unit, insert the connector until the connector is seated.

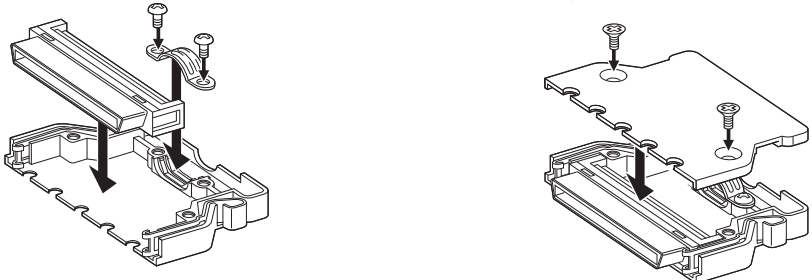

5. FUNCTION

5.1 External I/O function

The external I/O function enables external inputs and external outputs (lamps and relays) with the external I/O unit. No drawing software settings are required with the external I/O function.

保証について

当社の責に帰することができない事由から生じた損害、当社製品の故障に起因するお客様での機会損失、逸失利益、当社の予見の有無を問わず特別の事情から生じた損害、二次災害、事故補償、当社製品以外への損傷およびその他の業務に対する保証については、当社は責任を負いかねます。

- △ 安全にお使いいただくために
- この製品は一般工業を対象とした汎用品として製作されたもので、人命にかかわるような状況下で使用される機器あるいはシステムに用いられることを目的として設計、製造されたものではありません。
 - この製品を原子力用、電力用、航空宇宙用、医療用、乗用移動体用の機器あるいはシステムなどの特殊用途への適用をご検討の際には、当社の営業担当窓口までご相談ください。
 - この製品は厳重な品質管理体制のもとに製造しておりますが、この製品の故障による重大な事故または損失の発生が予測される設備への適用に際しては、バックアップやフェールセーフ機能をシステムの設計にしてください。

お問い合わせ先については、GOT に同梱されている概要説明書を参照してください。

本マニュアルは、輸出する場合、経済産業省への役務取引許可申請は不要です。

この印刷物は 2025 年 12 月の発行です。
 なお、お断りなしに仕様を変更することがありますのでご了承ください。

- With an external input, GOT internal devices of GB30 to 37 and GB50 to 57 (16 points) turn on.
Operate the GOT when GB30 to 37 and GB50 to 57 turn on.
- An external output is executed when GOT internal devices of GB10 to 25 (16 points) turn on.
GOT internal devices used for the external I/O function are shown below.

Device No.	Description
GB10 to GB25	Y0 to YF are ON after GB devices are ON.
GB30 to GB37	ON when X0 to X7 are input
GB50 to GB57	ON when X8 to XF are input

- With the external I/O notification and control function (GS517.b0), up to 128 points can be input.
For details, refer to the following manuals.
- GT Designer3 (GOT3000) Screen Design Manual
- GT Designer3 (GOT2000) Screen Design Manual
- GT Designer3 Version1 Screen Design Manual (Functions)

5.2 Operation panel function

For details on the operation panel function, refer to the following manuals.

- GT Designer3 (GOT3000) Screen Design Manual
- GT Designer3 (GOT2000) Screen Design Manual
- GT Designer3 Version1 Screen Design Manual (Functions)

To use the external I/O unit, make the communication settings.
For the setting details, refer to the following manuals:

- GOT3000 Series User's Manual (Connection)
- GOT2000 Series Connection Manual (Microcomputers, MODBUS/
Fieldbus Products, Peripherals) For GT Work3 Version1
- GOT1000 Series Connection Manual (Microcomputer, MODBUS
Products, Peripherals).

Warranty

Mitsubishi Electric will not be held liable for damage caused by factors found not to be the cause of Mitsubishi Electric; machine damage or lost profits caused by faults in the Mitsubishi Electric products; damage, secondary damage, accident compensation caused by special factors unpredictable by Mitsubishi Electric; damages to products other than Mitsubishi Electric products; and to other duties.

-  For safe use
- This product has been manufactured as a general-purpose part for general industries, and has not been designed or manufactured to be incorporated in a device or system used in purposes related to human life.
 - Before using the product for special purposes such as nuclear power, electric power, aerospace, medicine or passenger movement vehicles, consult with Mitsubishi Electric.
 - This product has been manufactured under strict quality control. However, when installing the product where major accidents or losses could occur if the product fails, install appropriate backup or failsafe functions in the system.

Inquiry
For the inquiries, refer to the general description included with the GOT.

Specifications subject to change without notice.
Printed in Japan, December 2025.

三菱電機株式会社：〒100-8310 東京都千代田区丸の内2-7-3（東京ビル）
HEAD OFFICE: TOKYO BLDG., 2-7-3, MARUNOUCHI, CHIYODA-KU, TOKYO 100-8310, JAPAN
NAGOYA WORKS: 1-14, YADA-MINAMI 5-CHOME, HIGASHI-KU, NAGOYA 461-8670, JAPAN

2025 年 12 月作成