

BEFORE USE

Thank you for choosing M-System. Before use, check the contents of the package you received as outlined below. If you have any problems or questions with the product, please contact M-System’s Sales Office or representatives.

■ PACKAGE INCLUDES:

- Mounting Pole..... (1)
- Mounting fixture*
 - M5 screw (4)
 - Washer..... (4)
 - Spring washer..... (4)
 - Nut (4)

* Included for circular base mount type.

■ MODEL NO.

Confirm that the model number described on the product is exactly what you ordered.

■ INSTRUCTION MANUAL

This manual describes necessary points of caution when you use this product and installation procedures.

POINTS OF CAUTION

■ GENERAL PRECAUTIONS

- Before you remove the unit or mount it, turn off the power supply and signals for safety.
- The unit must not be subjected to external force.
- Do not rub the unit with organic solvent like paint thinner.

■ ENVIRONMENT

- Indoor use
- Do not install the unit where it is subjected to continuous vibration. Do not subject the unit to physical impact.
- Environmental temperature must be within -10 to +55°C (14 to 131°F) with relative humidity within 30 to 90% RH in order to ensure adequate life span and operation.
- Install the unit at a location that has sufficient strength.
- Recommended tightening torque for bolts and nuts
 - M3: 0.3 – 0.4 N·m
 - M5: 1.4 – 1.6 N·m
 - M8: 6.1 – 6.3 N·m
 - M17: 24 – 26 N·m
- Hexagon socket set screw: 1.1 – 1.2 N·m

■ INGRESS PROTECTION

Circular base mount type

- Degree of protection: IP65
- The IP code is conformable when the unit is mounted vertically. The bottom of the pole is excluded.
- In order to prevent ingress of water or dust from the bottom of the pole, mount the unit such that the gasket at the bottom of the pole fits closely to the flat plane, after making sure the gasket does not turn up and there is no adhesion of dust. The unit may not satisfy the degree of protection due to improper mounting.

L-shaped mount type

- Degree of protection: IP13
- The IP code is conformable when the unit is mounted vertically.

INSTALLATION

- Refer to the following instructions, “EXTERNAL DIMENSIONS” and “MOUNTING REQUIREMENTS”.
- Remove nuts from bolts of tower light and insert the bolts into holes of flange, and then fasten the tower light and mounting pole together with the removed nuts. Use a nut driver which has 9 mm or less outer diameter of the socket. (Torque: 0.3 – 0.4 N·m) Temporarily remove the pole by loosening hexagon socket set screws of the flange, if it is necessary depending on the shape of the driver. (Torque: 1.1 – 1.2 N·m)

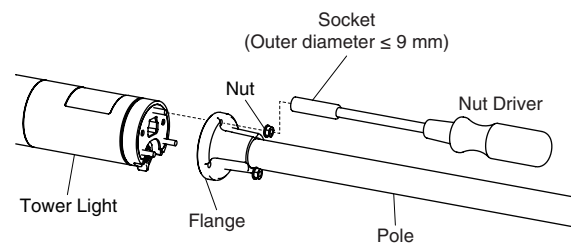

- M17 nuts for the L-shaped bracket are temporarily locked. Re-tighten them firmly after adjusting the position. (Torque: 24 – 26 N·m)

EXTERNAL DIMENSIONS unit: mm

■ CIRCULAR BASE MOUNT TYPE

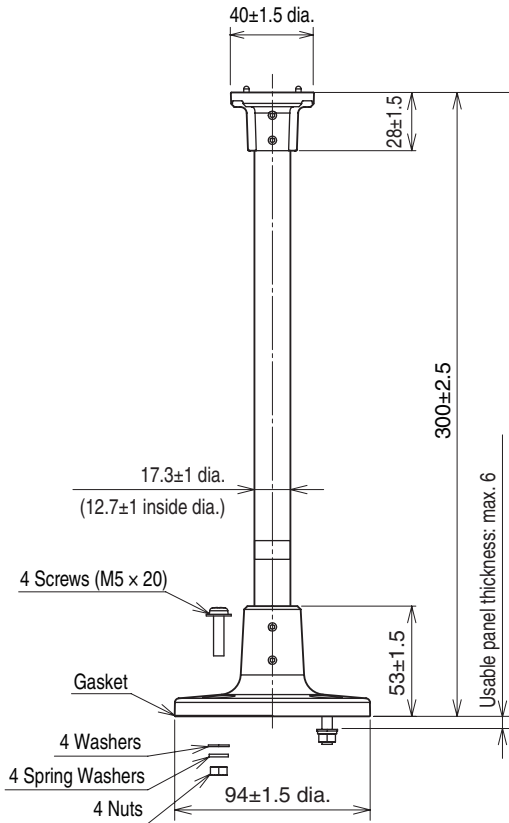

■ L-SHAPED MOUNT TYPE

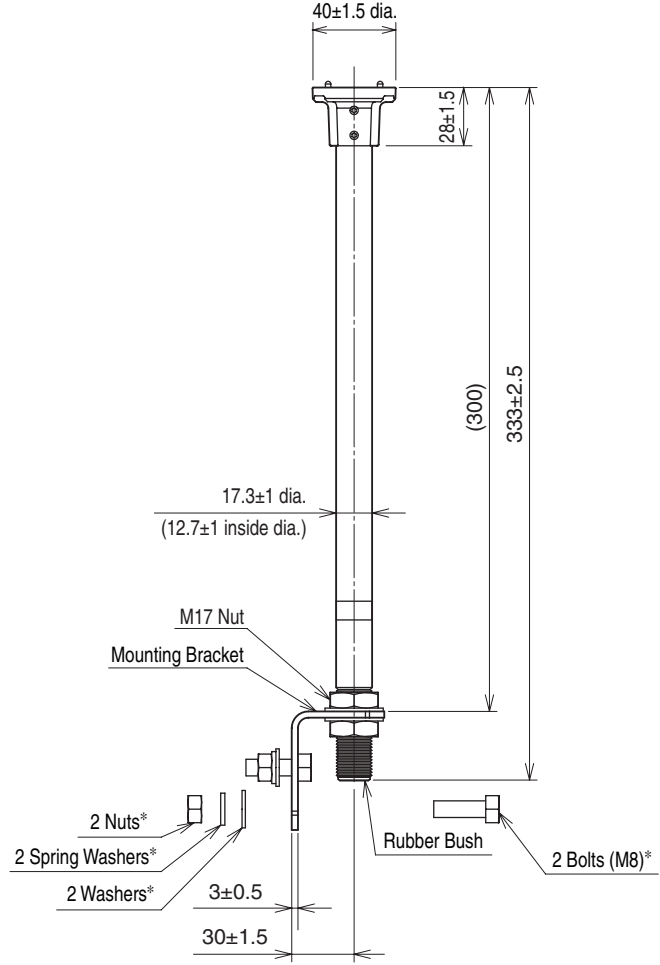

* Not included with product package.

MOUNTING REQUIREMENTS mm (inch)

■ CIRCULAR BASE MOUNT TYPE

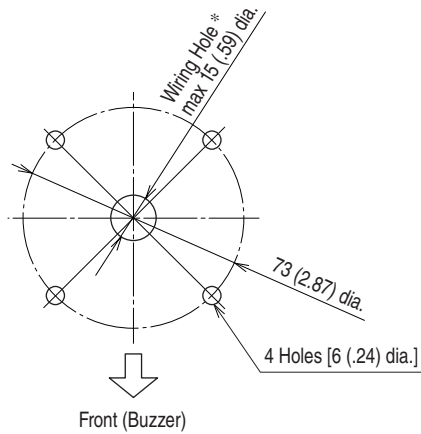

■ L-SHAPED MOUNT TYPE

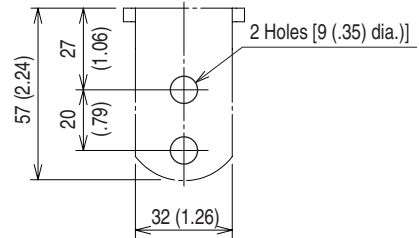

* Protect wires to prevent scratching them on edges.
Determine the hole diameter according to the size of the wires.